

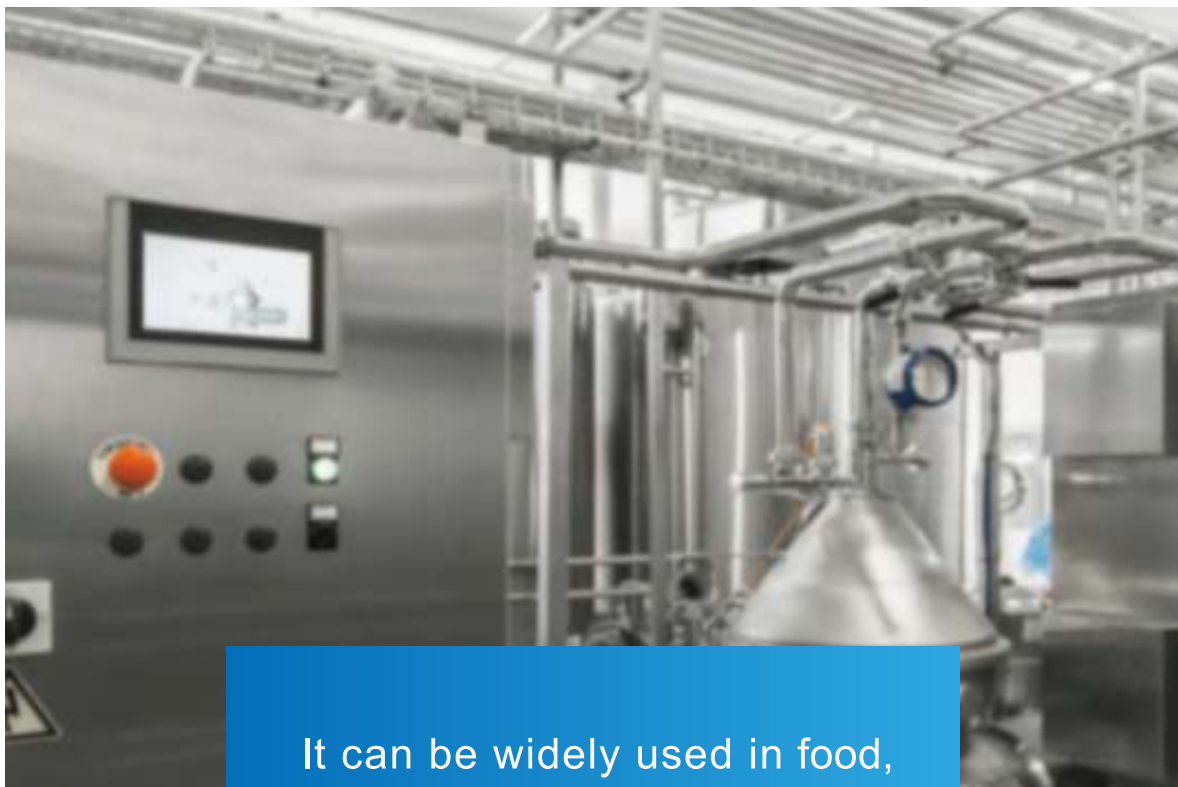

GM9907 Series

Touch Screen Weighing Controller

Making the World Measurable Linking Your Smart Life



It can be widely used in food, feed, seed, fertilizer, powder and other industries.

User-friendly Design, Easy Operation

- 7-inch Touch screen for displaying clearly and operating easily, simplex/duplex scale interface mode switching;
- Different types of Home Screen for Different Application;



- All Parameter Matched and Displayed according to the Scale;



- Modular design, guided step-by-step operation, one key switch;

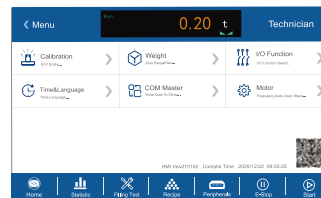

- Screen Saver Displaying after the Set Time, Dynamic display of operating status and data;

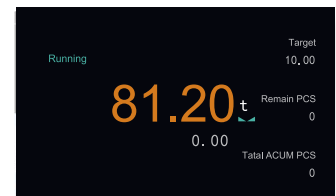

Intelligent Function Design, Smart Operation

- Self-adaptive Function, Support a variety of scale structure mode;

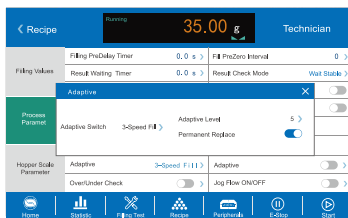

- USB for importing and exporting data, upgrading software and customizing boot screen, etc.

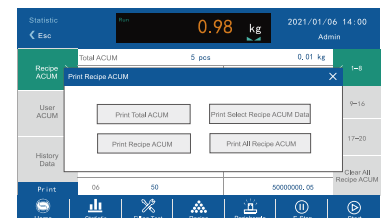
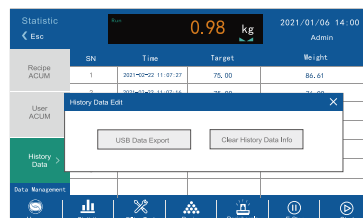

- Host Mode: Can be Used as Industrial Control Panel to Configure PLC or Transducer.



GM9907-L2/LD

Packing Controller

(L2:Simplex Packing LD:Duplex Packing)



GM9907-L2/LD is the simplex/duplex packing controller , widely used for, granule packing scale, powder packing scale,big bag, valve type scale-cement, etc.

Version Features

User-Friendly · Better Experience

- Memory card build in, 7-inch Touch screen for displaying clearly and operating easily, Single/double scale interface mode switching;

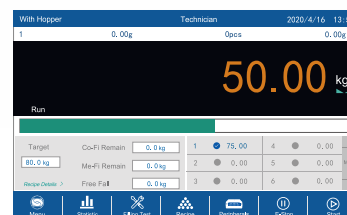
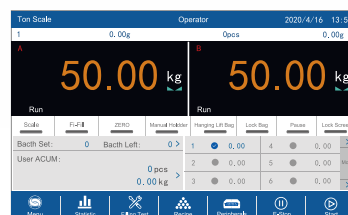

- **L2:** Simplex packing; **LD:** Duplex packing; can be choosed, interface displayed accordingly;

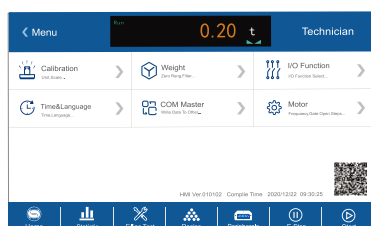

- Multi-Mode: With Hopper, No Hopper, Big Bag Scale, Valve Scale, PLC;

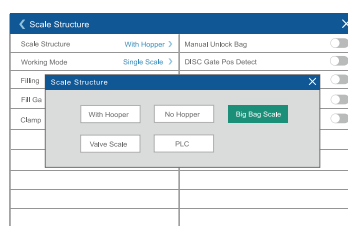

- Self-Adaptive: I/O Programmable;

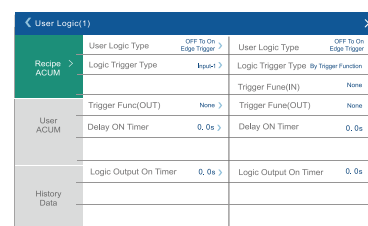

Communication

RS485+RS232

- For connecting PC, PLC, Printer, Label Printer, Remote Display, Code Printer, or other external devices, for reading and setup remotely;

USB

- For importing and exporting recipes, works, I/O function communication and other parameters, upgrading system software, customizing boot screen, etc;

12 Input/16 Output

- For starting, stopping, feeding, unloading, clamping/loosening bags, etc;

Modbus TCP

- For connecting PC, PLC, Printers, etc., for reading remotely.

Specification

| Model | | GM9907-L2/LD |
|-----------------------------------|---|-----------------------------------|
| General Specification | Power Supply | DC24V |
| | Operating Temperature | -10~40℃ |
| | Maximum Humidity | 90%R.H without dew |
| | Test Standard | Class III 6000e, 1μV/d |
| | Power Consume | About 15W |
| Measurement parameters | A/D converter type | 24 bit Sigma-Delta |
| | A/D Conversion Rate | 120/240/480/960 times /per second |
| | Non-Linear | 0.01%F.S |
| | Gain Drifting | 10PPM/℃ |
| | Minimum Sensitivity | 0.02μV/d |
| | Analog Input Range | 0.02~15mV |
| | Display Accuracy | 1/100,000 |
| | Power Source for Load Cell | DC5V 125mA(MAX) |
| | Input Resistance | 10MΩ |
| | Zero Point Adjustment Range | 0.002~15mV (load cell 3mV/V) |
| I/O Interfaces and Communications | 12 Input 16 Output, I/O Selectable | |
| | 12 Input, Active-low | |
| | Start, Emergency stop, Stop, Zeroing, Clear alarm, Clear total ACUM, Bag Lock/Unlock, Manual discharge, Manual fine flow, Manual coarse flow, Change recipe, Empty material | |
| | 16 Output, Single drive current 500mA | |
| | Run, Stopped, Coarse flow, Medium flow, Fine flow, Bag lock, Result waiting, Ready, Discharge, -NZ-, Pat bag, FILL, EMPT, Alarm, Batch complete, Over/Under | |

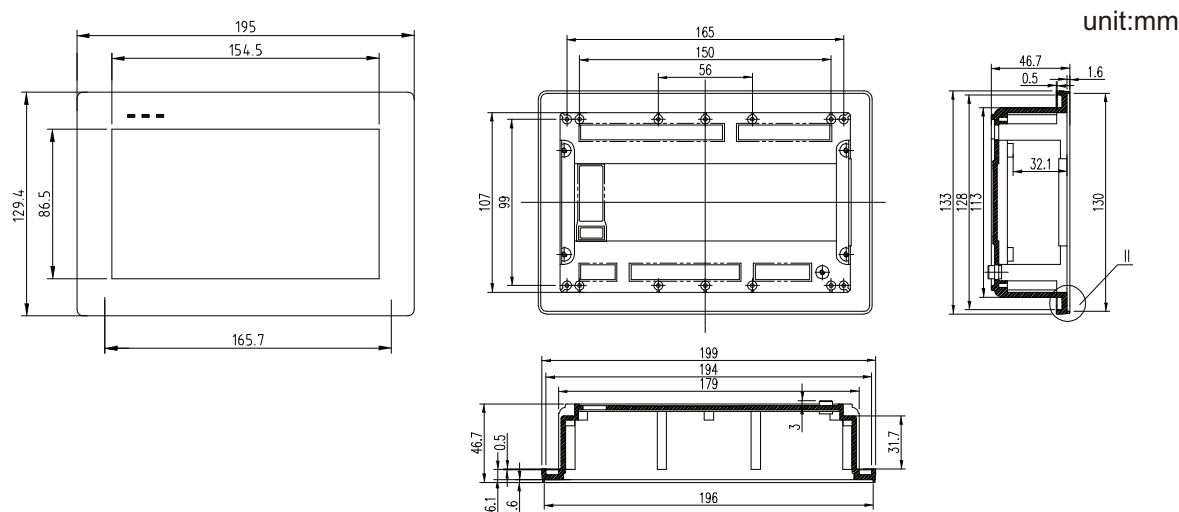

Application Schematic Diagram

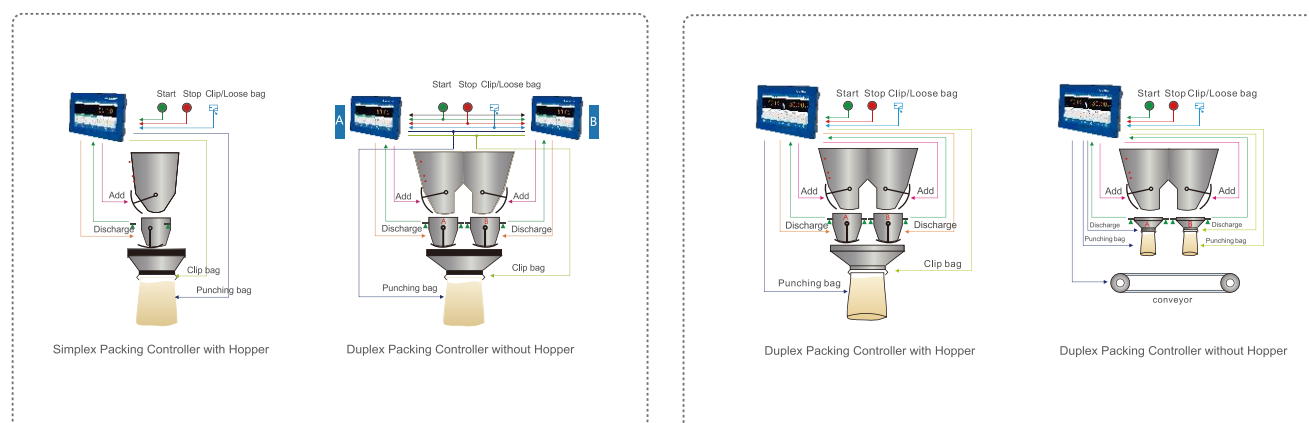

GM9907-L2

GM9907-LD

GM9907-L4

Reduce weight method packing controller



GM9907-L4 is designed for Loss-in-weight bagging machine. It can be widely used in rice, grains, feeds, chemical industry, etc.

Version Features

User-Friendly · Better Experience

- Memory card build in, 7-inch Touch screen for displaying clearly and operating easily;

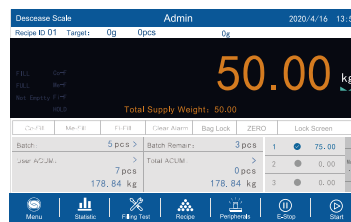

- It can store 20 groups of recipes, 9 groups of users accumulation data;



- Data backup and recovery function can save the optimal parameters and improve the working efficiency;

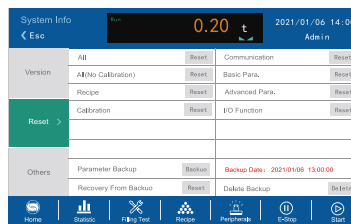

- Starting Patting mode when filling material to shape bags by setting relevant parameter;

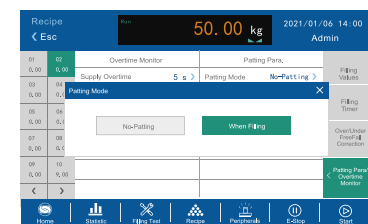

Communication

RS485+RS232

- For connecting PC, PLC, Printer, Label Printer, Remote Display, Code Printer, or other external devices, for reading and setup remotely;

USB

- For importing and exporting recipes, works, I/O function communication and other parameters, upgrading system software, customizing boot screen, etc;

Modbus TCP

- For connecting PC, PLC, Printers, etc., for reading remotely.

Specification

| Model | | GM9907-L4 |
|-----------------------------------|---|--|
| General Specification | Power Supply | DC24V |
| | Operating Temperature | -10~40℃ |
| | Maximum Humidity | 90%R.H without dew |
| | Test Standard | Class III 6000e,1μV/d |
| | Power Consume | About 15W |
| Measurement parameters | A/D converter type | 24 bit Sigma-Delta |
| | A/D Conversion Rate | 120/240/480/960 times /per second |
| | Non-Linear | 0.01%FS |
| | Gain Drifting | 10PPM/℃ |
| | Minimum Sensitivity | 0.02μV/d |
| | Analog Input Range | 0.02~15mV |
| | Display Accuracy | 1/100,000 |
| | Power Source for Load Cell | DC5V 125mA(MAX) |
| | Input Resistance | 10MΩ |
| | Zero Point Adjustment Range | 0.002~15mV (load cell 3mV/V) |
| I/O Interfaces and Communications | 2 Input 16 Output, I/O Selectable | |
| | 12 Input, Active-low | |
| | Start, Emergency stop, Stop, Zeroing, Clear alarm, Change recipe, Bag Lock/Unlock, Manual discharge, Manual fine flow, Manual coarse flow, Clear total ACUM, etc. | |
| | 16 Output, Single drive current 500mA | |
| | | Run, Stopped, Coarse flow, Medium flow, Fine flow, Bag lock, Result waiting, Pat bag, FILL, Batch complete, Supply full, Pause, etc. |

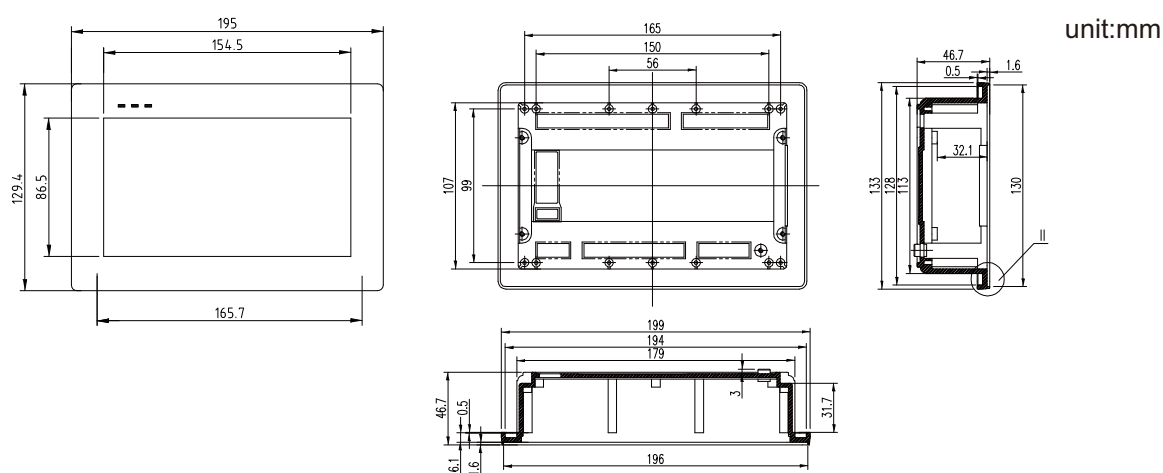

Application Schematic Diagram

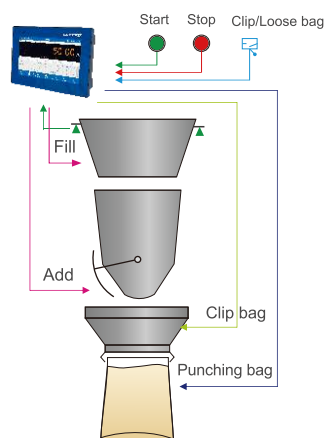

Reduce weight method packing

GM9907-L5

Bulk Scale Controller (Continuous Weighing)



GM9907-L5 is designed for bulk scale to solve the problem of batch weight and automatic totalizing of incoming and outgoing material. It can be widely used in chemical, grain, feeds, construction and harbor logistics industry, etc.

Version Features

User-Friendly · Better Experience

- Memory card build in, 7-inch Touch screen for displaying clearly and operating easily;

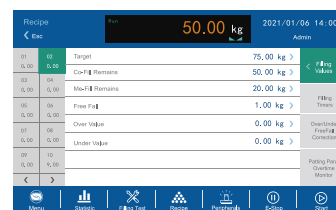
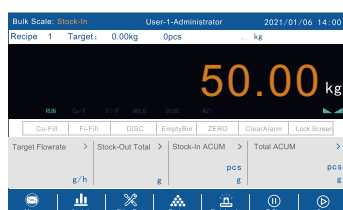

- Flow rate function can discharge material automatically and alarm when flow rate is low, which is more intelligent;



- Two scale mode: Stock-In or Stock-Out; Data information is more convenient to operate;

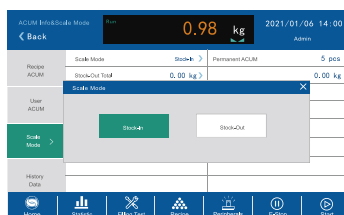

- Two packing mode: Motor or Pneumatic; Add/Discharge feed is more convenient;



Communication

RS485+RS232

- For connecting PC, PLC, Printer, Label Printer, Remote Display, Code Printer, or other external devices, for reading and setup remotely;

USB

- For importing and exporting recipes, works, I/O function communication and other parameters, upgrading system software, customizing boot screen, etc;

Modbus TCP

- For connecting PC, PLC, Printers, etc., for reading remotely.

Specification

| Model | | GM9907-L5 |
|-----------------------------------|---|-----------------------------------|
| General Specification | Power Supply | DC24V |
| | Operating Temperature | -10~40℃ |
| | Maximum Humidity | 90%R.H without dew |
| | Test Standard | Class III 6000e,1μV/d |
| | Power Consume | About 15W |
| Measurement parameters | A/D converter type | 24 bit Sigma-Delta |
| | A/D Conversion Rate | 120/240/480/960 times /per second |
| | Non-Linear | 0.01%F.S |
| | Gain Drifting | 10PPM/℃ |
| | Minimum Sensitivity | 0.02μV/d |
| | Analog Input Range | 0.02~15mV |
| | Display Accuracy | 1/100,000 |
| | Power Source for Load Cell | DC5V 125mA(MAX) |
| | Input Resistance | 10MΩ |
| I/O Interfaces and Communications | Zero Point Adjustment Range | 0.002~15mV (load cell 3mV/V) |
| | 12 Input 16 Output, I/O Selectable | |
| | 12 Input, Active-low | |
| | Start, Emergency stop, Stop, Zeroing, Clear alarm, Fill permission, Clogged, Manual fine flow, etc. | |
| | 16 Output, Single drive current 500mA | |
| | Run, Stopped, Clogged, Coarse flow, Fine flow, Result waiting, Over/under, Alarm, Stock-out Done, Last feed, DISC, -NZ-, etc. | |

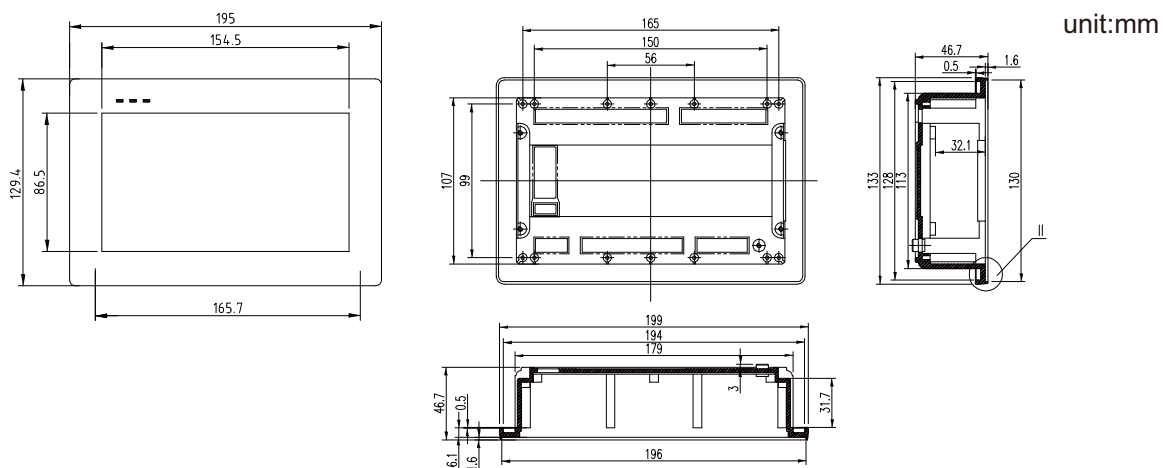

Application Schematic Diagram

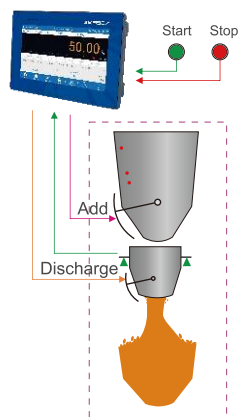

Continuous Weighing

GM9907-LB

Batching Scale Controller



GM9907-LB is designed for batching scale that can sort feeding orders of a variety of materials. It can be widely used in concrete mixing, bituminous mixing, metallurgy, chemical, feeds industry, etc.

Version Features

User-Friendly · Better Experience

- Memory card build in, Dynamic batching process can be graphically displayed for better understanding and monitoring;

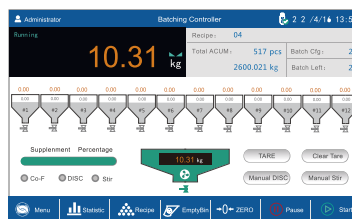

- Support the batching of 12 kinds of materials. It can be customized according to the batching process sequence, which is flexible to use;

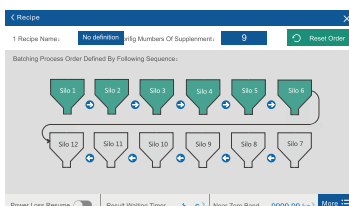

- The working process is clear. Feeding value and time of the material can be set, and real-time feeding dynamic can be displayed;

| Recipe | Supplement2 | Filling PreDelay Timer | .5s > |
|--------------------|-------------|--------------------------|-------|
| Target | 5 . kg > | COMP.Inhibit Timer(Co-F) | .5s > |
| Co-Fill Ramen | 1 . kg > | COMP.Inhibit Timer(Me-F) | .5s > |
| Me-Fill Ramen | 3 . kg > | COMP.Inhibit Timer(F-F) | .5s > |
| Free Fall | .1 kg > | Str Control | .5s > |
| Over Limit Value | .5 kg > | | |
| Under Limit Value | .5 kg > | | |
| Fill Pause Control | | | |

- User-friendly design: Save function when power down and monitoring alarm function;

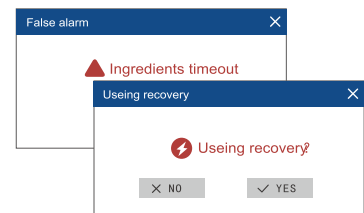

Communication

RS485+RS232

- For connecting PC, PLC, Printer, Label Printer, Remote Display, Code Printer, or other external devices, for reading and setup remotely;

USB

- For importing and exporting recipes, works, I/O function communication and other parameters, upgrading system software, customizing boot screen, etc;

12 Input/16 Output

- For starting, stopping, feeding, unloading, clamping/loosening bags, etc;

Modbus TCP

- For connecting PC, PLC, Printers, etc., for reading remotely.

Specification

| Model | | GM9907-LB |
|-----------------------------------|--|-----------------------------------|
| General Specification | Power Supply | DC24V |
| | Operating Temperature | -10~40 C |
| | Maximum Humidity | 90%R.H without dew |
| | Test Standard | Class III 6000e,1μV/d |
| | Power Consume | About 15W |
| Measurement parameters | A/D converter type | 24 bit Sigma-Delta |
| | A/D Conversion Rate | 120/240/480/960 times /per second |
| | Non-Linear | 0.01%F.S |
| | Gain Drifting | 10PPM/ C |
| | Minimum Sensitivity | 0.02μV/d |
| | Analog Input Range | 0.02~15mV |
| | Display Accuracy | 1/100,000 |
| | Power Source for Load Cell | DC5V 125mA(MAX) |
| | Input Resistance | 10MΩ |
| | Zero Point Adjustment Range | 0.002~15mV (load cell 3mV/V) |
| I/O Interfaces and Communications | 12 Input 16 Output, I/O Selectable | |
| | 12 Input, Active-low | |
| | Start, Emergency stop, Stop, Pause, ZERO, Clear alarm, Change recipe, M-DISC permission, TARE, Clear tare, Manual stir, etc. | |
| | 16 Output, Single drive current 500mA | |
| | Run, Stopped, Coarse flow, Medium flow, Fine flow, Result waiting, Over/under, DiSC, -NZ-, Alarm, Stir, etc. | |

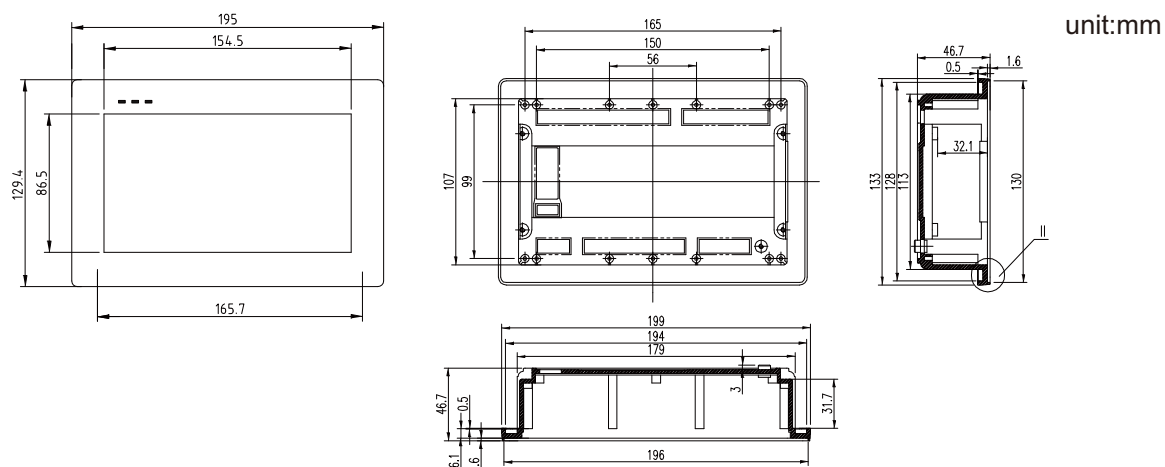

Application Schematic Diagram

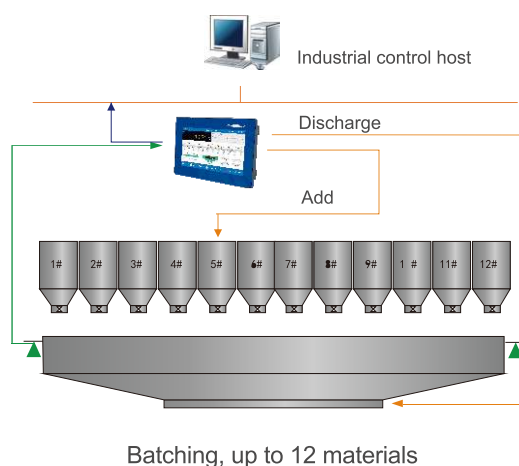

ENTERPRISE PROFILE

**30⁺**
years

Industry Experience

**40⁺**

Country Sales

**100⁺**

R&D Patent

**2000⁺**

Application of the scene

General Measure established in 1993, as one of China's earliest industrial weighing company who is also a national high-tech enterprise, has over 50 people in the R&D team. For 28 years, we have been committed to improving the automatic process of industrial weighing and the precision of weighing control.

In 2003, we began to open the overseas market. Since 2006, General Measure dominated the high-end market and occupying more than 25% of the market in China. To expand the global business scale, we have been focusing on overseas markets since 2012. It has been seen that the average sales growth is above 30% every year.

We will continue to provide reliable industrial weighing indicators and equipment with excellent performance and weighing solutions with innovative value to our partners. Listening, Innovating, and growing together is our value, which guides us to achieve win-win cooperation by helping clients achieve their goals.

Combining cutting-edge technology to
disrupting the industry status-quo, making weighing
more accessible.



Global Clients **2000+**

ZOOMLION

prompt
We Promise. We Deliver.

CONCH

**DIGITAL
SCALE**

FAMSUN
牧羊丰尚

muyuan牧原

PESAR
PRECISION GROUP

altus

中国邮政
CHINA POST

wilmar

Amul

BCI
INGENIERIA



[Linkedin](#)



[Facebook](#)



[Wechat](#)



General Measure Technology Co.,Ltd.

Address: Room2208, Block A, Building 6, Shenzhen International Innovation Valley,
Nanshan District, Shenzhen, Guangdong Province, P.R.China.

Tel/Wechat: +86 185 6585 5789

E-mail: xjlv@szgmt.com

Website: www.gmweighing.com